

**NOTES:**

1. POST AND RAILING MATERIAL TO BE GLULAM PORT ORFORD CEDAR, 22F-VPOC2, ARCHITECTURAL APPEARANCE. TREATMENT TO BE DETERMINED BY BELLEVUE PARKS.
2. WHERE PLATES ATTACH TO LANDING SIDES, USE  $\frac{3}{4}$ "x $\frac{6}{8}$ " MACHINE BOLTS IN LIEU OF  $\frac{3}{4}$ "x12" LAG BOLTS.
3. WHERE PLATES ATTACH TO POSTS AT RAIL BREAKS, USE  $\frac{3}{4}$ "x4" MACHINE BOLTS IN LIEU OF  $\frac{3}{4}$ "x12" LAG BOLTS.
5. ALL CONNECTING HARDWARE TO BE HOT DIPPED GALVANIZED.

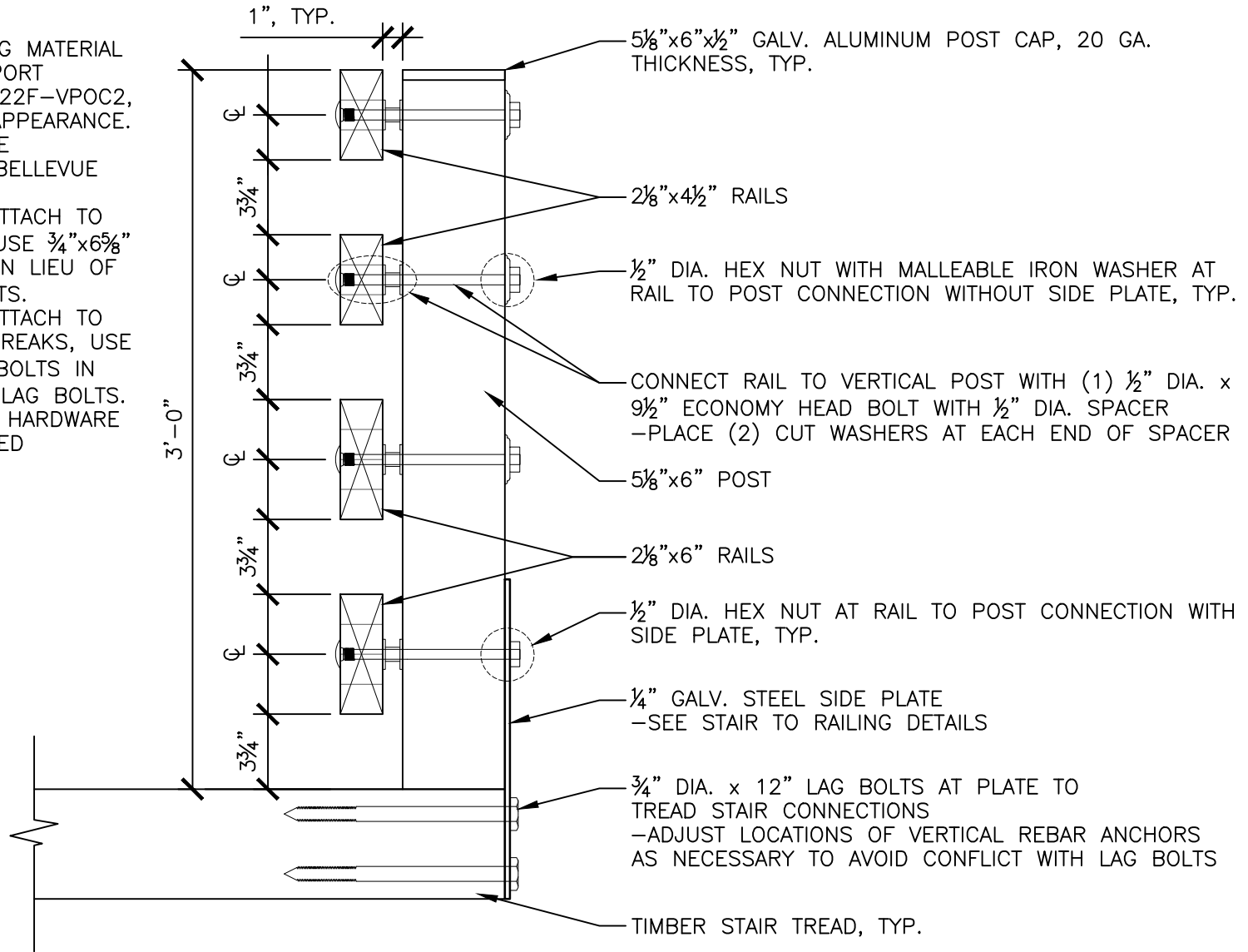

City of  
Bellevue

TITLE:

COAL CREEK NATURAL AREA - TRAIL - TIMBER  
STAIRS - RAILING - SECTION

DRAWING #:	PK-CC-08A
SCALE:	N.T.S.
REVISION DATE:	12-2018
DEPARTMENT:	PARKS